

# PARTS LIST & DIAGRAM

## A-935 HVLP GRAVITY GUN

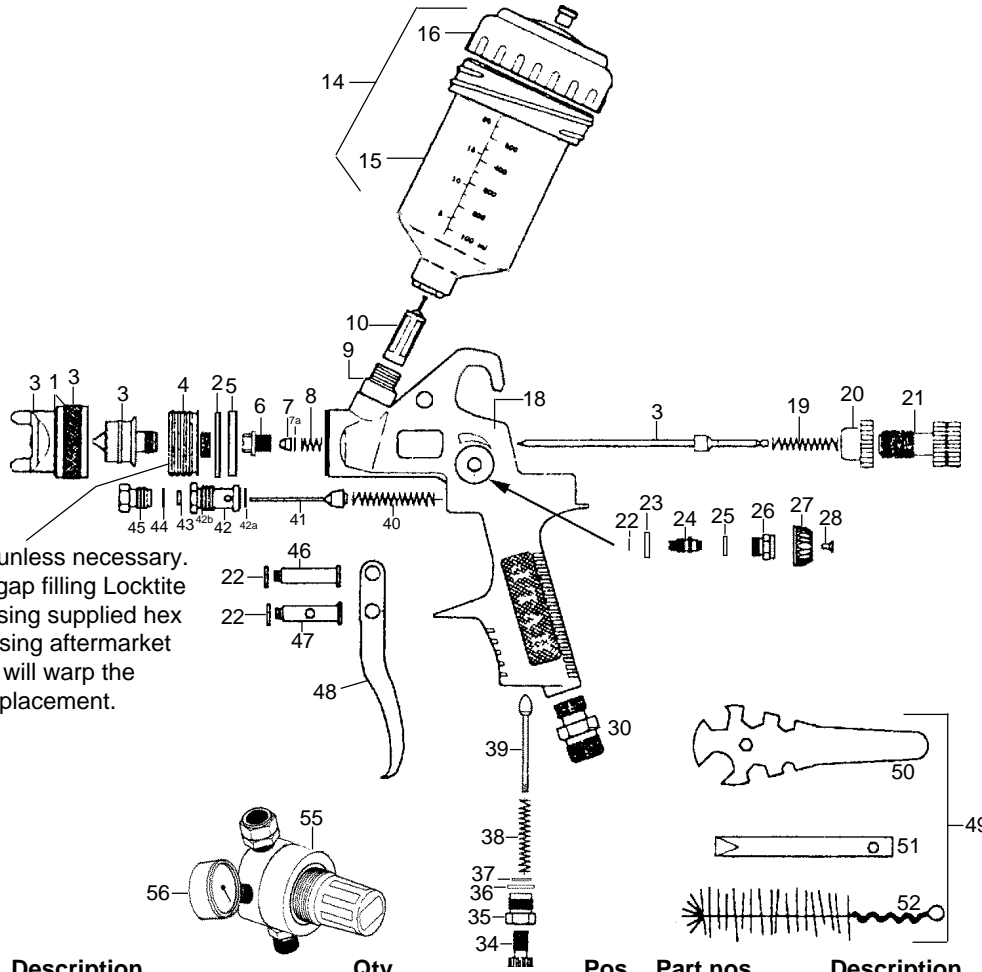

#4 - Do not remove unless necessary. To reassemble use gap filling Loctite #567, then tighten using supplied hex wrench. Do not try using aftermarket allen key on #4 as it will warp the brass and require replacement.

Pos.	Part nos.	Description	Qty.
	<b>L015-008</b>	<b>A-935 HVLP -600cc nylon gravity cup</b>	
	<b>L015-009</b>	<b>A-935 HVLP -600cc aluminum gravity cup</b>	
1	L015-400	Snap ring, air cap	1
	L015-469	Retaining washer, air cap	
2	L015-401	Air cap seal	1
3	L015-402	Nozzle kit, 1.0 mm	1
	L015-403	Nozzle kit, 1.5 mm	1
	L015-404	Nozzle kit, 2.0 mm	1
	L015-405	Nozzle kit, 2.5 mm	1
4	L015-410	Air distribution adapter (see note above)	1
5	L015-411	Air distribution gasket	1
6	L015-412	Packing nut	1
*7	L015-413	Needle packing	1
7a		Teflon o-ring, flat	1
8	L015-414	Locking spring	1
9	L015-415	Cup connector	1
10	L015-416	Cup filter	1
14	L015-475	Gravity cup w/ lid, 600cc Nylon	1
	L015-485	Gravity cup w/ lid, 600cc Alum New 2013	1
	L015-476	Gravity cup w/ lid, 600cc Alu old nyl lid opt	
15	L015-486	Gravity cup bare, 600cc Alum New 2013	1
16	L015-487	Cup lid, Alum New 2013	1
	L015-488	Cup lid seal, Alum New 2013	1
	L015-478	Cup cover (nylon for old 600cc alum cup)	opt
18	L015-421	Gun body	1
19	L015-422	Needle spring	1
20	L015-423	Locking ring	1
21	L015-424	Material control knob	1
22	L015-425	C-clip	3

Pos.	Part nos.	Description	Qty.
*23	L015-426	O-ring	1
24	L015-427	Fan adjusting screw	1
25	L015-428	Washer	1
26	L015-429	Retaining nut	1
27	L015-430	Fan control knob	1
28	L015-431	Phillips screw	1
30	L015-432	Air inlet fitting	1
34	L015-433	Air adj. knob	1
35	L015-434	Air adj. housing	1
*36	L015-435	O-ring	1
37	L015-436	Washer	1
38	L015-437	Air flow spring	1
39	L015-438	Air flow stem	1
40	L015-439	Air valve spring	1
*41	L015-440	Air valve stem	1
42	L015-441	Air valve body	1
42a		Teflon o-ring	1
42b		Rubber o-ring	1
*43	L015-442	O-ring	1
*44	L015-443	Flex washer	1
45	L015-444	Retaining nut	1
46	L015-445	Trigger pin, upper	1
47	L015-446	Trigger pin, lower	1
48	L015-447	Trigger	1
49	L015-448	Tool Kit	1
50	L015-449	Multi flat wrench	1
51	L015-450	Packing tool	1
52	L015-451	Cleaning brush	1
55	L015-452	Regulator with gauge	1
56	L015-453	Air gauge	1

**Accessories:**

\* L015-454 Seal kit, A935 (consisting of items marked \*)