

Kit Contents

- | | |
|------------------------|------------------------|
| 8-Piece Kit: | 2-Piece Kit: |
| • 7 - Splitters | • 2 - Splitters |
| • 8 - 5' Harnesses | • 2 - 5' Harnesses |
| • 8 - Flush LED Lights | • 2 - Flush LED Lights |
| • 8 - White Trim Rings | • 2 - White Trim Rings |
| • 8 - Black Trim Rings | • 2 - Black Trim Rings |

Tools Needed

- Power drill
- 1-1/4" diameter Forstner Bit or Bi-Metal Hole Saw

Preparation

- Do not cut any wires. Any extra wire length can be coiled up.
- If using insulated wire staples to hold the wires in place, be sure not to pierce or crush the wires.
- During installation, it is recommended that you temporarily cover the photocell on the transformer with dark tape so the lights will be on when you plug them in. This will help check for any issues during installation. Remove tape when done.
- Wiring harness should have enough slack so light fixture can be removed if future replacement is needed.
- Do not look directly into the light.
- For use with 12-volt, low-voltage outdoor landscape lighting system only.

Installation Instructions

Step 1: Prepare the Transformer: Follow instructions provided with the transformer.

Step 2: Layout the location of the light(s). To prevent splitting, do not install within 1/2" of the edge of the light and the edge the deck board (fig. 1).

Important Note: Please make sure that you have properly calculated your distances and are confident of the positioning of the lights before drilling holes.

Step 3: Use a 1-1/4" Diameter Forstner Bit or Bi-Metal Hole Saw to bore a flat bottom hole through the deck board (fig. 2). Disconnect the male end of the harness from the female end of the light. Insert the male end of the harness through the back of the drilled hole.

Step 4: Insert the wire of the recessed deck light into the hole of the trim ring accessory, and press the face of the light so it is flush with the lip of the trim ring (fig. 3). Choice of black or white trim rings provided in the kit.

Step 5: Plug the male connector of the harness from Step 3 into the female connector attached to the light (fig. 4).

Step 6: Connection is fully engaged when there is minimal gap between the male and female connector (fig. 5).

Step 7: Firmly insert the connected harnesses first, followed by the trim ring and seated light, into the hole drilled in Step 3. Press firmly until the lip of the trim ring rests atop the surface of the deck board (fig. 6).

Step 8: The recessed deck light will now be illuminated if the transformer is on and providing power.

Note: If the drilled hole is too loose to hold the light snugly, a small amount of silicone caulk on the inside of the hole is recommended to hold the light in place.

One flush mount light kit contains:



Recessed Deck Light
with Trim Ring

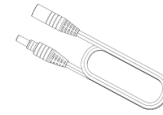

Harness

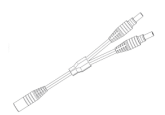

2 Output
Splitter

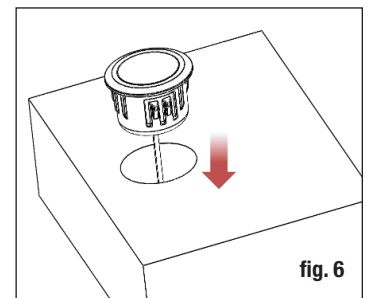
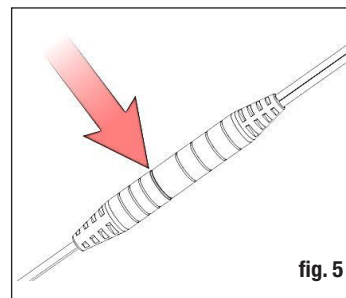
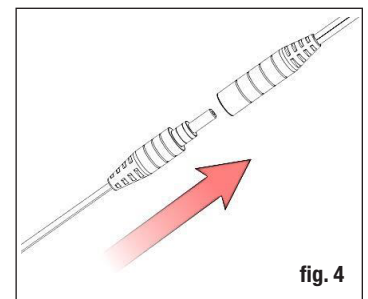
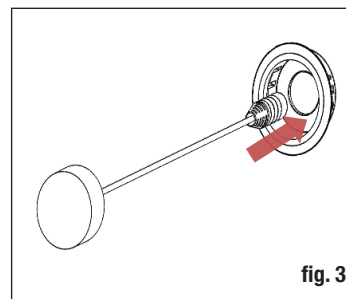
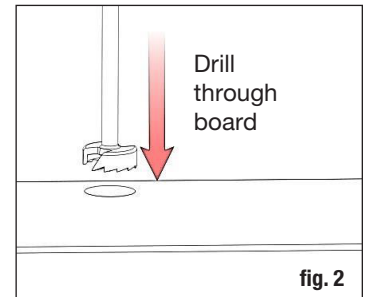
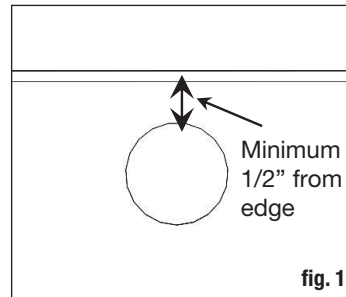

THE DIAGRAMS AND INSTRUCTIONS IN THIS BROCHURE ARE FOR ILLUSTRATION PURPOSES ONLY AND ARE NOT MEANT TO REPLACE A LICENSED PROFESSIONAL. ANY CONSTRUCTION OR USE OF THE PRODUCT MUST BE IN ACCORDANCE WITH ALL LOCAL ZONING AND/OR BUILDING CODES. THE CONSUMER ASSUMES ALL RISKS AND LIABILITY ASSOCIATED WITH THE CONSTRUCTION OR USE OF THIS PRODUCT. THE CONSUMER OR CONTRACTOR SHOULD TAKE ALL NECESSARY STEPS TO ENSURE THE SAFETY OF EVERYONE INVOLVED IN THE PROJECT, INCLUDING, BUT NOT LIMITED TO, WEARING THE APPROPRIATE SAFETY EQUIPMENT. EXCEPT AS CONTAINED IN THE WRITTEN LIMITED WARRANTY, THE WARRANTOR DOES NOT PROVIDE ANY OTHER WARRANTY, EITHER EXPRESS OR IMPLIED, AND SHALL NOT BE LIABLE FOR ANY DAMAGES, INCLUDING CONSEQUENTIAL DAMAGES.